

Support Information

USA

+ 1 800 255 4101
support@zyxel.com

EU

https://support.zyxel.eu

EU Importer

Zyxel Communications A/S
Gladsaxevej 378, 2. th. 2860 Søborg, Denmark
https://www.zyxel.com/dk/da/

US Importer

Zyxel Communications, Inc
1130 North Miller Street Anaheim, CA 92806-2001
https://www.zyxel.com/us/en/

Copyright © 2020 Zyxel Communications Corp. All Rights Reserved.

Environmental Warning

Dispose of your fiber module according to all national laws and regulations.

Introduction

Use a transceiver module for connection to a remote device. SFP+ transceiver modules are hot swappable. You can install and remove a module while your device is operating.

SFP+ modules use 3.3 V power input and SC-type connector.

SFP+ modules support data rate of 10 Gbps and single-mode connection.

Handling Warning

All modules are static sensitive. To prevent damage from electrostatic discharge (ESD), it is recommended you attach an ESD preventive wrist strap to your wrist and to a bare metal surface when you install or remove a module.

1 Installing a Module

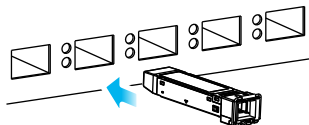

- EN ① Attach an ESD preventive wrist strap to your wrist and to a bare metal surface.
- ② Remove the module from its protective packaging.
- ③ Align the module with the slot opening on the device.
- ④ Make sure the latch is in the lock position, then insert the module into the slot until the module snaps into place.

Note: Module installation orientation varies depending on your device. Your module comes with a mechanism that prevents incorrect insertion. Do NOT force or twist the module into a slot.

2 Connecting a Fiber Cable

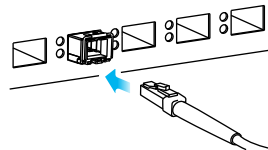

- EN ① Remove the dust plugs from the module and cables.
- ② Align the fiber cable with the module. Then insert the fiber cable into the module.

1 Removing a Fiber Cable

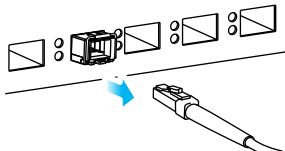

- EN ① Attach an ESD preventive wrist strap to your wrist and to a bare metal surface on the chassis.
- ② Disconnect all fiber cables from the SFP+ module.
- ③ When a fiber cable is not in use, we recommend you put the dust plug on to avoid getting dust into it.

2 Unlocking a Module

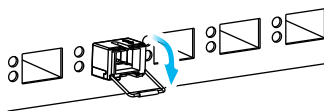

- EN ① Pull out the latch and down to unlock a module.

3 Removing a Module

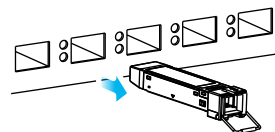

- EN ① Pull the latch, or use your thumb and index finger to grasp the tabs on both sides of the module, and carefully slide it out of the slot.
Note: Do NOT force or twist the module out of a slot. If the module will not slide out, grasp the tabs on both sides of the module with a slight up/down motion and carefully slide it out of the slot. If unsuccessful, contact Zyxel Support to prevent damage to your Zyxel Device and module.
- ② When a module is not in use, we recommend you put the dust plug on to avoid getting dust into it.