

# Quick Start Guide

## PMG3000-D20B

Gigabit GPON SFP-Type SFU



ZYXEL

### Overview

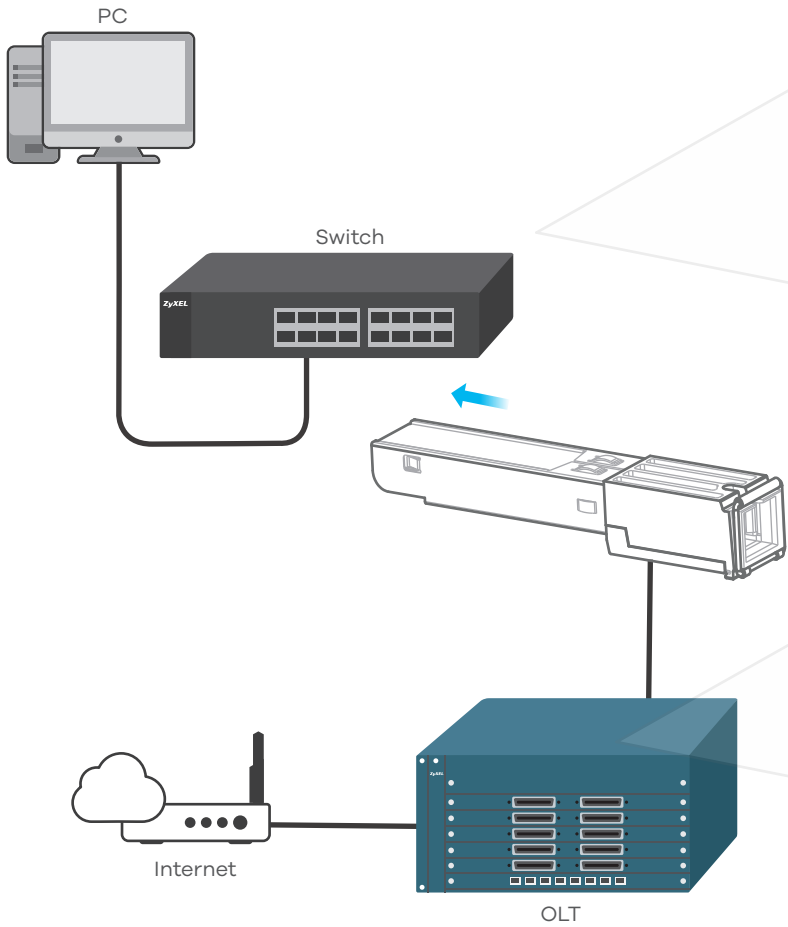

### Hardware Installation - Transceiver Installation

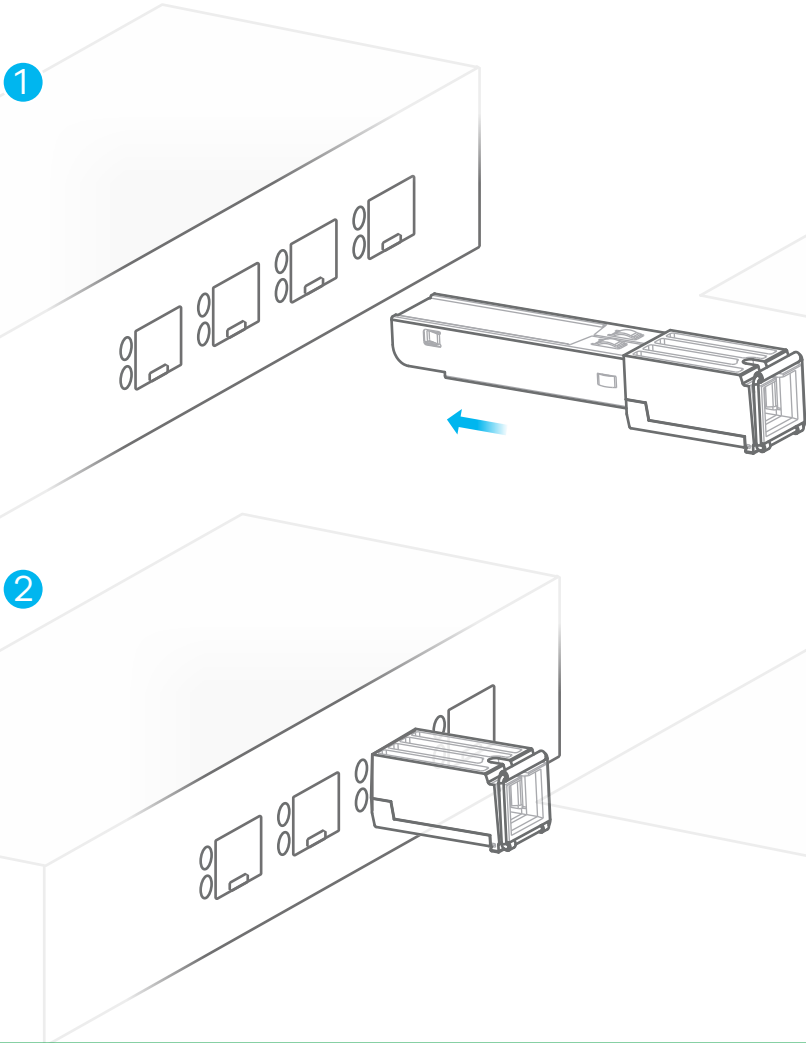

### Hardware Installation - Transceiver Removal

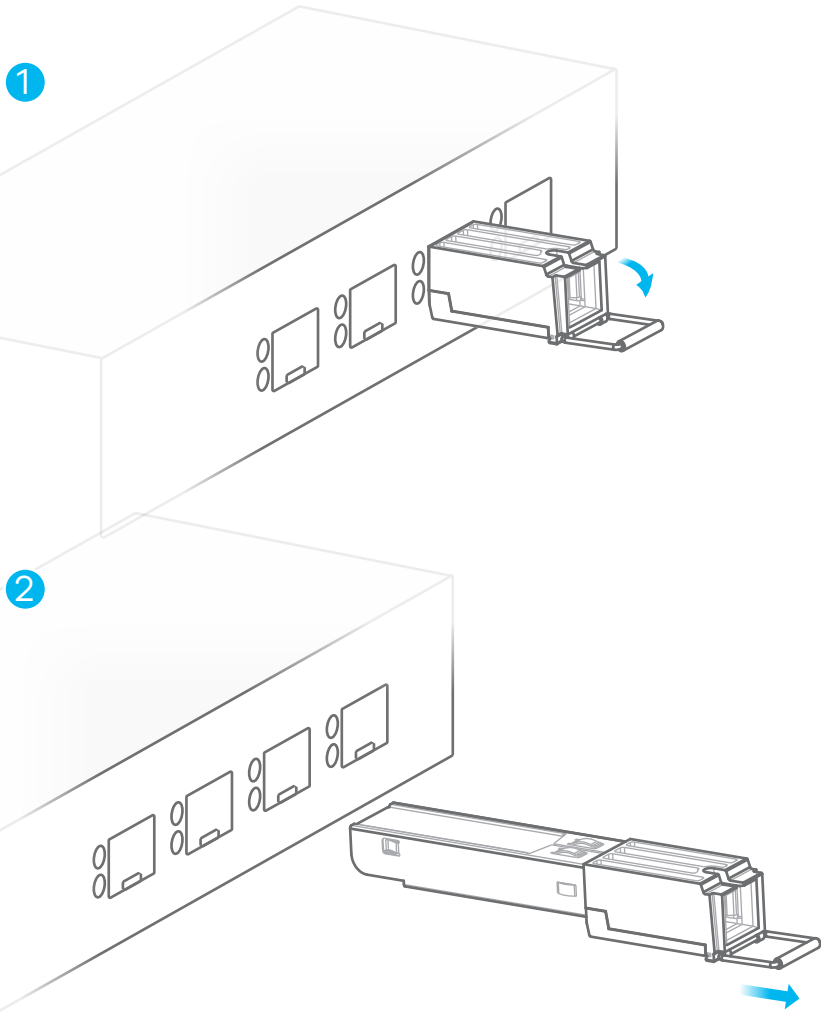

### Safety Warnings

- Ground yourself (by properly using an anti-static wrist strap for example) whenever working with the device's hardware or connections.
- Do NOT use this product near water, for example, in a wet basement or near a swimming pool.
- Do NOT expose your device to dampness, dust or corrosive liquids.
- Do NOT store things on the device.
- Do NOT install, use, or service this device during a thunderstorm. There is a remote risk of electric shock from lightning.
- Connect ONLY suitable accessories to the device.
- Do NOT open the device or unit. Opening or removing covers can expose you to dangerous high voltage points or other risks. ONLY qualified service personnel should service or disassemble this device. Please contact your vendor for further information.
- Make sure to connect the cables to the correct ports.
- Place connecting cables carefully so that no one will step on them or stumble over them.
- Always disconnect all cables from this device before servicing or disassembling.
- Use ONLY an appropriate power adaptor or cord for your device.
- Do not use the device outside, and make sure all the connections are indoors. There is a remote risk of electric shock from lightning.
- Make sure that the cable system is grounded so as to provide some protection against voltage surges.

**EN** The PMG3000-D20B is an GPON transceiver module that complies with the Small Form-factor Pluggable (SFP) Transceiver MultiSource Agreement (MSA). Installing the PMG3000-D20B in the SFP port on a switch lets the SFP port act as an optical network unit (ONU) that allows you to enjoy high-speed Internet access over optical networks. The PMG3000-D20B comes with one fiber port. No configuration is required as all device configuration is done remotely by the OLT (Optical Line Terminal). Once you have connected the hardware, you are ready to access the Internet.

**EN** To avoid possible eye injury, do not look into an operating fiber-optic module's connectors.

① Insert the PMG3000-D20B into an SFP port with the exposed section of PCB board facing down.

② Press the PMG3000-D20B firmly until it clicks into place.

The switch with the SFP port automatically detects the installed PMG3000-D20B. Check the LEDs to verify that it is functioning properly.

Use an SC/APC, single-mode optical cable to connect the PMG3000-D20B's PON port and an OLT for Internet access.

**EN** ① Remove the fiber optic cable from the PMG3000-D20B. Open the PMG3000-D20B's latch (latch styles vary).

② Pull the ONU5100-B22 out of the port.

### European Union - Disposal and Recycling Information

The symbol below means that according to local regulations your product and/or its battery shall be disposed of separately from domestic waste. If this product is end of life, take it to a recycling station designated by local authorities. At the time of disposal, the separate collection of your product and/or its battery will help save natural resources and ensure that the environment is sustainable development.



See the User's Guide at [www.zyxel.com](http://www.zyxel.com) for more information, including safety warnings and customer support.

EU Importer  
Zyxel Communication A/S  
Generatorvej 8D, 2860 Søborg, Denmark.  
<http://www.zyxel.dk>

US Importer  
Zyxel Communications, Inc  
1130 North Miller Street Anaheim, CA 92806-2001  
<http://www.us.zyxel.com>